



Flygt 2125.320

Table of Contents

1 Introduction.....	2
1.1 Specially approved products.....	2
2 Product Description.....	3
2.1 Products included.....	3
2.2 The data plate.....	3
2.3 Product denomination.....	3
3 Exploded View.....	5
3.1 2125.320.....	5
4 Spare Parts.....	6
4.1 2125.320.....	6

1 Introduction

Purpose of this manual

The purpose of this manual is to provide necessary information on spare parts and accessories order.

Disclaimer

Always use genuine Flygt parts. The use of other spare parts or accessories can invalidate any claims for warranty or compensation. Xylem does not take any responsibility for damages that are caused by the use of non-original parts. For more information, contact your local sales and service representative.

Data for ordering spare parts

The following information is needed for spare part orders:

- Serial number of the product
- Part number
- Quantity of bulk material, see * in tables

1.1 Specially approved products

Qualification of personnel

Only Xylem or Xylem-authorized service personnel may undertake repair work on specially approved products.

Dimensional accuracy inspection

Spare parts marked with (Ex) after the part number are subject to dimensional accuracy inspection when used in specially approved products.

2 Product Description

2.1 Products included

Pump model	Standard	EX	MSHA	Drainage	Sludge
2125.320	X			X	

2.2 The data plate

The data plate is a metal label that is located on the main body of the products. The data plate lists key product specifications. Specially approved products also have an approval plate.

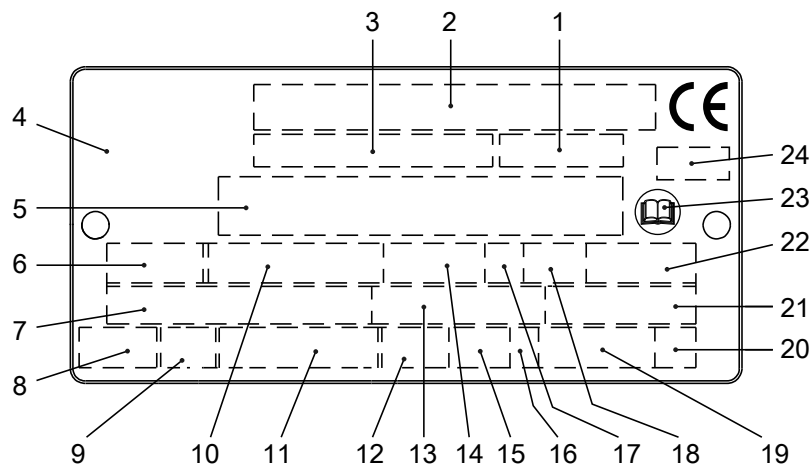

WS006257A

1. Curve code or Propeller code
2. Serial number
3. Product number
4. Country of origin
5. Additional information
6. Phase; type of current; frequency
7. Rated voltage
8. Thermal protection
9. Thermal class
10. Rated shaft power
11. International standard
12. Degree of protection
13. Rated current
14. Rated speed
15. Maximum submergence
16. Direction of rotation: L=left, R=right
17. Duty class
18. Duty factor
19. Product weight
20. Locked rotor code letter
21. Power factor
22. Maximum ambient temperature
23. Read installation manual
24. Notified body, only for EN-approved Ex products

Figure 1: The data plate

2.3 Product denomination

Reading instruction

In this section, code characters are illustrated accordingly:

X = letter

Y = digit

The different types of codes are marked up with a, b and c. Code parameters are marked up with numbers.

Codes and parameters

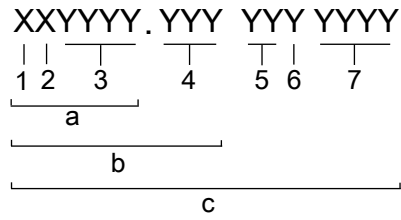

WS006265B

Type of Callout	Number	Indication
Type of code	a	Sales denomination
	b	Product code
	c	Serial number
Parameter	1	Hydraulic end
	2	Type of installation
	3	Sales code
	4	Version
	5	Production year
	6	Production cycle
	7	Running number

3 Exploded View

3.1 2125.320

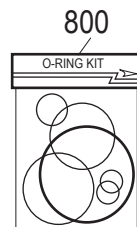
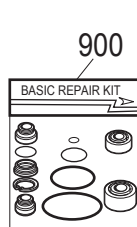
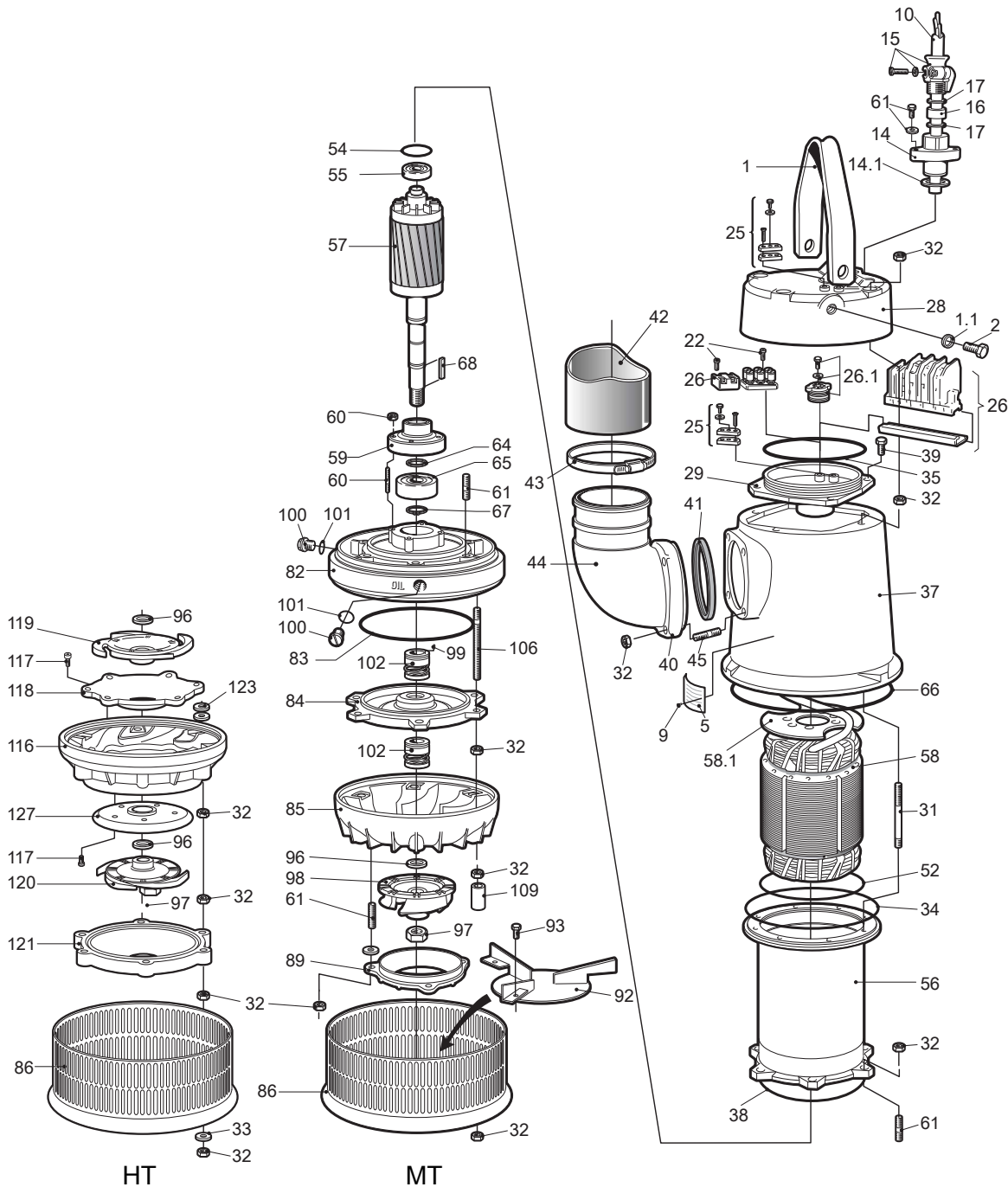

20207_2125.320

4 Spare Parts

4.1 2125.320

Pos. No	Part. No	Type	Denomination	Qty/Version
				320
1	305 99 00		Lifting handle	1
2	84 34 02		Hexagon head screw M16X35-A2-70	2
3	775 15 00		Connection plate	1
4	340 71 00		Instruction plate	1
5	630 68 00		Data plate USE 6306801 AS SPARE PART	1
8	667 40 01		Sticker	2
9	82 20 88		Drive screw 4X5-A2/A4	8
10	83 42 29		End sleeve 4 MM2; L=10 MM	3
			SUBCAB 10AWG/3-2-1-GC 20,30 - 22,30mm	
			SUBCAB 4G4+2x1,5 20 - 22mm	
			SUBCAB 7G4+2x1,5 22 - 26mm Star delta possible	
10	83 42 38		End sleeve 1.5 MM2; L=7 MM	2
			SUBCAB 4G6+2x1,5 23 - 25mm	
			SUBCAB 7G2,5+2x1,5 20 - 23mm Star delta possible	
			SUBCAB 4G4+2x1,5 20 - 22mm	
			SUBCAB 7G4+2x1,5 22 - 26mm Star delta possible	
10	83 42 30		End sleeve 6 MM2; L=10 MM	3
			SUBCAB 4G6+2x1,5 23 - 25mm	
			SUBCAB 8AWG/4 24 - 26mm	
			SUBCAB 10AWG/3-2-1-GC 20,30 - 22,30mm	
10	83 42 20		End sleeve (1.5)-2.5 MM2; L=6.9MM	6
			SUBCAB 7G2,5+2x1,5 20 - 23mm Star delta possible	
10	83 42 29		End sleeve 4 MM2; L=10 MM	6
			SUBCAB 10AWG/3-2-1-GC 20,30 - 22,30mm	
			SUBCAB 4G4+2x1,5 20 - 22mm	
			SUBCAB 7G4+2x1,5 22 - 26mm Star delta possible	
10	83 42 29		End sleeve 4 MM2; L=10 MM	2
			SUBCAB 10AWG/3-2-1-GC 20,30 - 22,30mm	
			SUBCAB 4G4+2x1,5 20 - 22mm	
			SUBCAB 7G4+2x1,5 22 - 26mm Star delta possible	
12	792 06 00		El-lead through 6X + 2X	1
14	619 28 00		Entrance flange	1
14,1	82 74 64		O-ring 54.5X3 NBR	1
15	442 57 00		Motor cable entry	1
			No of cable entries: 1 (20)-22mm	
			No of cable entries: 1 (18)-20mm	
15	254 03 11		Motor cable entry	1
			No of cable entries: 1 (22)-26mm	
16	84 35 34		Seal sleeve (18)-20 MM CR	1
			No of cable entries: 1 (18)-20mm	
16	84 35 35		Seal sleeve (20)-22 MM CR	1
			No of cable entries: 1 (20)-22mm	

Pos. No	Part. No	Type	Denomination	Qty/Version	
				320	
16	84 35 36		Seal sleeve (22)-24 MM CR	No of cable entries: 1 (22)-26mm	1
16	84 35 37		Seal sleeve (24)-26 MM CR	No of cable entries: 1 (22)-26mm	1
17	82 40 59		Plain washer 20.5X35X2-A2-70	No of cable entries: 1 (18)-20mm	2
17	82 40 60		Plain washer 22.5X35X2-A2-70	No of cable entries: 1 (20)-22mm	2
17	82 40 61		Plain washer 24.5X35X2-A2-70	No of cable entries: 1 (22)-26mm	2
17	82 40 62		Plain washer 26.5X35X2-A2-70	No of cable entries: 1 (22)-26mm	2
22	81 73 75		Slotted head screw M6X16-A4-70	Terminal board Max 690V	2
22	81 73 40		Slotted head screw M4X8-A4-70	Terminal board Max 1000V	2
25	81 95 54		Slotted head screw 1/4 UNCX22-2343		2
26	281 68 00		Terminal board unit	Terminal board Max 690V	1
26	694 88 00		Con.term.board unit	Terminal board Max 1000V	1
28	619 29 00		Entrance cover		1
29	619 26 00		Bearing housing unit		1
32	82 24 53		Hexagon nut 1/2 UNC-A2-70		12
33	82 35 21		Plain washer 10X18X2-A2-A 140		3
33	82 35 21		Plain washer 10X18X2-A2-A 140		12
34	82 74 99		O-ring 259.3X5.7 NBR		1
35	82 74 90		O-ring 184.3X5.7 NBR		1

Pos. No	Part. No	Type	Denomination	Qty/Version
				320
36	83 42 29		End sleeve 4 MM ² ; L=10 MM	6

Pos. No	Part. No	Type	Denomination	Qty/Version	
				320	
36	83 42 29		End sleeve 4 MM2; L=10 MM	3-phase 50 Hz 2-poles 380V-400V Y 220V-230V D P2=8kW Max ambient temp=40 DC Thermal contact 3-phase 60 Hz 2-poles 440V-460V Y 260V D P2=9,70kW/13hp Max ambient temp=40 DC Thermal contact 3-phase 50 Hz 2-poles 380V-400V D 660V-690V Y P2=8kW Max ambient temp=40 DC Thermal contact 3-phase 60 Hz 2-poles 440V-460V D P2=9,70kW/13hp Max ambient temp=40 DC Thermal contact 3-phase 60 Hz 2-poles 440V-460V YSER 220V-230V Y// P2=9,70kW/13hp Max ambient temp=40 DC Thermal contact 3-phase 60 Hz 2-poles 380V D P2=9,70kW/13hp Max ambient temp=40 DC Thermal contact 3-phase 50 Hz 2-poles 400V-440V D P2=8kW Max ambient temp=40 DC Thermal contact 3-phase 50 Hz 2-poles 500V D P2=8kW Max ambient temp=40 DC Thermal contact 3-phase 60 Hz 2-poles 575V-600V D P2=9,70kW/13hp Max ambient temp=40 DC Thermal contact 3-phase 50 Hz 2-poles 550V D 1000V Y P2=8kW Max ambient temp=40 DC Thermal contact 3-phase 60 Hz 2-poles 1100V Y P2=9,70kW/13hp Max ambient temp=40 DC Thermal contact	9
37	619 23 00		Outer casing	1	
38	82 74 93		O-ring 199.3X5.7 NBR	1	
39	81 51 96		Hexagon head screw 3/8 UNCX19-A2-70	4	
40	619 33 00		Connection flange	1	
41	275 17 00		U-ring	1	
43	84 55 56		Hose clamp OUTER DIA 90-110 MM	2	
44	619 34 00		Discharge connection DN75	DN 75 Hose	1
44	621 47 00		Discharge connection 4"	DN 100 Hose	1
44	663 77 00		Discharge connection 4"	DN 100 Thread : ISO G4A Outer	1
45	81 02 16		Stud UPS1/2UNCX60-A2-70	4	
52	82 74 92		O-ring 194.3X5.7 NBR	1	
54	82 77 95		O-ring 52.5X3.0 NBR	1	
55	83 32 45		Ball bearing 25X52X15 MM	1	
56	619 24 00		Stator housing	1	
57	275 26 04	(Ex)	Shaft unit	1	

Pos. No	Part. No	Type	Denomination	Qty/Version
				320
58	623 94 02		Stator 19-13-2f 3-phase 50 Hz 2-poles 380V-400V Y 220V-230V D P2=8kW Max ambient temp=40 DC Thermal contact 3-phase 60 Hz 2-poles 440V-460V Y 260V D P2=9,70kW/13hp Max ambient temp=40 DC Thermal contact	1
58	623 94 01		Stator 19-13-2f 3-phase 50 Hz 2-poles 380V-400V D 660V-690V Y P2=8kW Max ambient temp=40 DC Thermal contact 3-phase 60 Hz 2-poles 440V-460V D P2=9,70kW/13hp Max ambient temp=40 DC Thermal contact	1
58	623 94 07		Stator 19-13-2f 3-phase 50 Hz 2-poles 400V-440V D P2=8kW Max ambient temp=40 DC Thermal contact	1
58	623 94 08		Stator 19-13-2f 3-phase 50 Hz 2-poles 500V D P2=8kW Max ambient temp=40 DC Thermal contact 3-phase 60 Hz 2-poles 575V-600V D P2=9,70kW/13hp Max ambient temp=40 DC Thermal contact	1
58	623 94 06		Stator 19-13-2f 3-phase 60 Hz 2-poles 440V-460V YSER 220V-230V Y// P2=9,70kW/ 13hp Max ambient temp=40 DC Thermal contact	1
58	623 94 05		Stator 19-13-2f 3-phase 60 Hz 2-poles 380V D P2=9,70kW/13hp Max ambient temp=40 DC Thermal contact	1
58	623 94 09		Stator 19-13-2f 3-phase 50 Hz 2-poles 550V D 1000V Y P2=8kW Max ambient temp=40 DC Thermal contact 3-phase 60 Hz 2-poles 1100V Y P2=9,70kW/13hp Max ambient temp=40 DC Thermal contact	1
59	619 25 00		Bearing cover	1
61	81 02 14		Stud UPS1/2UNCX50-A2-70	6
64	696 16 02		Supporting washer	1
65	83 30 17		Ball bearing 35X80X34.9 MM	1
66	82 75 04		O-ring 319.3X5.7 NBR	1
67	82 59 03		Retaining ring SGA 35	1
68	80 70 58		Parallel key 6X6X50	1
82	619 27 00		Bearing housing	1
83	82 74 95		O-ring 219.3X5.7 NBR	1
84	619 32 00		Bearing hous.cover	1
85	621 45 00		Diffuser coat. MT	1
85	619 31 00		Diffuser coat. HT	1
86	345 20 00		Strainer Strainer	1
86	622 23 00		Strainer compl. Strainer	1
89	621 46 00		Suction cover MT	1
89	635 39 00		Suction cover HT	1

Pos. No	Part. No	Type	Denomination	Qty/Version
				320
92	345 21 01		Rotation device unit Strainer	1
92	622 21 00		Rotation device unit Strainer	1
93	81 48 30		Hexagon head screw M6X25-A4-70	3
94	82 48 89		Spring washer DIN 127-B-6-A4	3
95	82 23 31		Hexagon nut M6-A4-70	3
96	247 00 00		Washer 24.5X36X0.3	6
96	247 00 01		Washer 24.5X36X1.5	2
96	247 00 00		Washer 24.5X36X0.3	15
96	247 00 01		Washer 24.5X36X1.5	5
97	192 20 02		Impeller nut	1
98	275 22 00		Impeller 231 MT 50Hz 3-phase Max ambient temp=40 DC Mtrl. Hard-Iron TM	1
98	275 22 02		Impeller 232 MT 60Hz 3-phase Max ambient temp=40 DC Mtrl. Hard-Iron TM	1
98	520 82 00		Impeller 241 MT 50Hz 3-phase Max ambient temp=40 DC Mtrl. Stainless steel (ASTM 329)	1
98	520 82 01		Impeller 242 MT 60Hz 3-phase Max ambient temp=40 DC Mtrl. Stainless steel (ASTM 329)	1
99	80 51 49		Grooved pin	2
100	281 98 00		Inspection screw	2
101	82 73 90		O-ring 19.2X3 NBR	2
102	720 85 00		Mechanical seal WCCR/WCCR FPM, NBR	1
106	275 39 00		Stud L=150	6
109	345 24 00		Sleeve 14X22X38 MT B DN 100 Diffusor material: NBR	6
109	285 40 00		Sleeve 28X38X32 Option	1
117	82 10 26		Hex.socket hd screw UC6S 1/4UNCX13-2343	5
118	288 57 03		Diffuser disc	1
119	383 22 04		Impeller 233 HT 50Hz 3-phase Max ambient temp=40 DC Mtrl. Hard-Iron TM	1
119	383 22 05		Impeller 234 HT 60Hz 3-phase Max ambient temp=40 DC Mtrl. Hard-Iron TM	1
119	520 28 00		Impeller 243 HT 50Hz 3-phase Max ambient temp=40 DC Mtrl. Stainless steel (ASTM 329)	1
119	520 28 01		Impeller 244 HT 60Hz 3-phase Max ambient temp=40 DC Mtrl. Stainless steel (ASTM 329)	1
120	383 21 04		Impeller 233 HT 50Hz 3-phase Max ambient temp=40 DC Mtrl. Hard-Iron TM	1
120	383 21 05		Impeller 234 HT 60Hz 3-phase Max ambient temp=40 DC Mtrl. Hard-Iron TM	1
120	520 29 00		Impeller 243 HT 50Hz 3-phase Max ambient temp=40 DC Mtrl. Stainless steel (ASTM 329)	1

Pos. No	Part. No	Type	Denomination		Qty/Version
					320
120	520 29 01		Impeller	244 HT 60Hz 3-phase Max ambient temp=40 DC Mtrl. Stainless steel (ASTM 329)	1
123	250 48 00		Washer 13.5X24X0.3	HT	30
123	250 48 00		Washer 13.5X24X0.3	HT	57
123	250 48 01		Washer 13.5X24X0.5	HT	15
125	82 10 26		Hex.socket hd screw UC6S 1/4UNCX13-2343		6
127	277 63 01		Diffuser disc		1
130	82 24 53		Hexagon nut 1/2 UNC-A2-70		6
131	82 24 53		Hexagon nut 1/2 UNC-A2-70		6
132	82 24 53		Hexagon nut 1/2 UNC-A2-70		6
133	82 24 53		Hexagon nut 1/2 UNC-A2-70		3
134	82 24 53		Hexagon nut 1/2 UNC-A2-70		4
135	82 24 53		Hexagon nut 1/2 UNC-A2-70		4
136	82 24 53		Hexagon nut 1/2 UNC-A2-70		4
137	82 24 50		Hexagon nut 1/4 UNC-A2-70		4
138	82 24 53		Hexagon nut 1/2 UNC-A2-70		6
139	83 45 51		Cable tie 200X4.8		1
140	399 45 00		Socket wrench		1
141	433 47 02		Plate 35x0.5		1
142	398 21 00		Mounting socket	Option	1
142	398 26 00		Mounting socket	Option	1
142	398 27 00		Mounting socket	Option	1
143	427 13 00		Marking tape		1
144	83 42 96		Cable lug 2.5-6 MM2 M6	SUBCAB 4G6+2x1,5 23 - 25mm SUBCAB 10AWG/3-2-1-GC 20,30 - 22,30mm SUBCAB 4G4+2x1,5 20 - 22mm SUBCAB 7G4+2x1,5 22 - 26mm Star delta possible	1
144	83 43 36		Cable lug 6.1-10 MM2;M6	SUBCAB 8AWG/4 24 - 26mm SUBCAB 8AWG/3-2-1-GC 27,20 - 29,20mm	2
144	83 43 58		Cable lug UL/CSA 1.04-2.62 MM2 M6	SUBCAB 7G2,5+2x1,5 20 - 23mm Star delta possible	1
144	83 43 36		Cable lug 6.1-10 MM2;M6	SUBCAB 8AWG/4 24 - 26mm SUBCAB 8AWG/3-2-1-GC 27,20 - 29,20mm	1
144	83 42 96		Cable lug 2.5-6 MM2 M6	SUBCAB 4G6+2x1,5 23 - 25mm SUBCAB 10AWG/3-2-1-GC 20,30 - 22,30mm SUBCAB 4G4+2x1,5 20 - 22mm SUBCAB 7G4+2x1,5 22 - 26mm Star delta possible	2
145	94 05 17		Insulating hose D=20 MM		*
146	94 20 60		Motor cable subcab 4G4+2X1.5	SUBCAB 4G4+2x1,5 20 - 22mm	*

Pos. No	Part. No	Type	Denomination	Qty/Version	
				320	
146	94 20 56		Motor cable subcab 4G6+2X1.5	SUBCAB 4G6+2x1,5 23 - 25mm	*
146	94 20 82		Motor cable subcab 7G2.5+2X1.5	SUBCAB 7G2,5+2x1,5 20 - 23mm Star delta possible	*
146	94 20 80		Motor cable subcab 7G4+2X1.5	SUBCAB 7G4+2x1,5 22 - 26mm Star delta possible	*
146	94 21 07		Motor cable subcab 8 AWG/4	SUBCAB 8AWG/4 24 - 26mm	*
146	94 21 06		Motor cable	SUBCAB 10AWG/3-2-1-GC 20,30 - 22,30mm	*
147	81 41 31		Hexagon head screw M10X25-A2-70		2
148	81 73 44		Slotted head screw M4X16-A4-70		1
149	83 53 75		Connection term boar		1
151	248 02 00		Earthing screw		1
152	277 38 00		Earthing plate		1
153	277 39 00		Earthing plate		1
154	277 38 00		Earthing plate		1
155	277 39 00		Earthing plate		1
156	81 95 54		Slotted head screw 1/4 UNCX22-2343		2
157	81 02 14		Stud UPS1/2UNCX50-A2-70		3
158	275 18 01		Stud L=124		4
159	81 01 56		Stud UPS1/4UNCX40-A2-70		4
160	82 48 59		Spring washer FBB1/4"-A2-70		1
161	82 48 59		Spring washer FBB1/4"-A2-70		1
162	720 85 00		Mechanical seal WCCR/WCCR FPM, NBR		1
800	80 32 54		O-ring kits		1
801	454 22 21		Zinc anode kit		1
815	554 20 06		Starter START 356-600-A-PG-20	356 3-phase 50/60 Hz Max 600 V Current range: 13 - 18 A	1
815	554 21 06		Starter START 356-600-B-PG-20	356 3-phase 50/60 Hz Max 600 V Current range: 13 - 18 A Thermal contact supervision	1
815	554 20 07		Starter START 356-600-A-PG-25	356 3-phase 50/60 Hz Max 600 V Current range: 17 - 23 A	1
815	554 21 07		Starter START 356-600-B-PG-25	356 50/60 Hz Max 600 V Current range: 17 - 23 A Thermal contact supervision	1
900	601 90 04		Basic repair kit	TUNGSTEN CARBIDE - TUNGSTEN CARBIDE. TUNGSTEN CARBIDE - TUNGSTEN CARBIDE.	1
901	90 17 52		Oil ISO VG 32		*
902	90 20 54		Grease		*
903	90 33 50		Sealing compound LOCTITE 5983		*



ООО «Бауманс Груп» - официальный партнер фирмы Flygt в России.

Тел: +7 495 121 49 50

Эл. почта: info@baumgroup.ru

Сайт: www.baumgroup.ru